

CGT10N

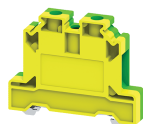

connectwell
THE RIGHT CONNECTION

10 sq.mm Ground / Earth Terminal Blocks

These Terminal Blocks are used for Grounding / Earthing Wires. They are Green-Yellow colour coded as per industries standard. They have the same top profile as their respective feed through Terminal Blocks.

TECHNICAL DATA

Tightening Torque	1.2 Nm
Housing Material	Polymide
Product Function	Earthing/Grounding
Wire Entry Orientation	Side Entry
Mounting Possibility	DIN 35/DIN 35-15 Rail
Screw Size	M4
Operated by	Screwdriver
Rated Surge Voltage	8 KV
Pollution Degree	3

CONNECTION DATA

Conductor Cross Section Stranded min.	0.2 mm ²
Conductor Cross Section Stranded max.	10 mm ²
Conductor Cross Section AWG/Kcmil min	16 AWG
Conductor Cross Section AWG/Kcmil max	6 AWG
Conductor Cross Section Stranded with Ferrule/Lug min	0.2 mm ²
Conductor Cross Section Stranded with Ferrule/Lug max	10 mm ²
2 Conductors with same Cross Section Stranded min	0.2 mm ²
2 Conductor with same Cross Section Stranded max	6 mm ²
2 Conductors with same Cross Section Stranded with TWIN Ferrule/Lug min	0.2 mm ²
2 Conductor with same Cross Section Stranded with TWIN Ferrule/Lug max	6 mm ²
Stripping Length	11 mm
Internal Cylindrical Guage	A6

DIMENSIONS

Height with DIN 35 x 15 mm rail	56 mm
Height with DIN 35 x 7.5 mm rail	48.5 mm
Length	55 mm
Width (Thickness)	10 mm

ORDERING INFORMATION

CAT. NO.	DESCRIPTION	STD. PACK
CGT10N	10 sq.mm Grounding / Earthing Terminal Block.	50

CGT10N

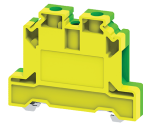

connectwell
THE RIGHT CONNECTION

APPROVALS



AEx ell Ex ell



RATINGS AS PER STANDARDS

STANDARDS	UL 1059	EN60079-7	CSA C.22.2 No:158
Approvals	UL	ATEX-IECex	CSA
Conductor Cross Section Stranded min.	16 AWG	1.5 mm ²	16 AWG
Conductor Cross Section Stranded max.	6 AWG	10 mm ²	6 AWG
Tightening Torque	14 lb-in	1.2 Nm	14 lb-in
STANDARDS	EN60079-7	IEC/EN60947-7-2	
Approvals	ATEX	CE	
Conductor Cross Section Stranded min.	1.5 mm ²	0.2 mm ²	
Conductor Cross Section Stranded max.	10 mm ²	10 mm ²	
Tightening Torque	1.2 Nm	1.2 Nm	
Operating Temperature Range	-40 to +85 °C		